

# LAR

FÁBRICA DE CADENAS  
CHAIN MANUFACTURER



CADENA EN TIRA

CADENA DIN 766

CADENA EN BOBINAS

CADENA ACERO INOXIDABLE AISI 316

CADENA EN FORMA PARA USOS  
AGRÍCOLAS Y GANADEROS

ACCESORIOS PARA CADENA EN FORMA

ACCESORIOS PARA CADENA Y CABLE

# CADENA COMERCIAL EN TIRA NEGRO NATURAL, PULIDA, CINCADADA Y GALVANIZADA AL FUEGO

COMMERCIAL CHAIN: SELF COLOUR, POLISHED, ZINC PLATED, AND HOT DIP GALVANISED

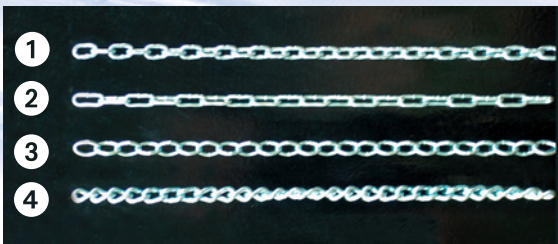

- ① CADENA DE ESLABÓN RECTO - NORMAL LINK CHAIN
- ② CADENA DE ESLABÓN LARGO - LONG LINK CHAIN
- ③ CADENA DE ESLABÓN OVALADO - OVAL LINK CHAIN
- ④ CADENA DE ESLABÓN RETORCIDO - TWISTED LINK CHAIN

## • CADENA DE ESLABÓN RECTO - NORMAL LINK CHAIN



Ø mm. (d.)	PASO t =	b =	CALIDAD NORMAL			PESO KG./MT.
			CARGA UTIL	CARGA DE PRUEBA	CARGA MINIMA DE ROTURA	
2	15	10	SIN GARANTIA			0,069
2,5	15	11,5	SIN GARANTIA			0,111
3	18	11	SIN GARANTIA			0,155
4	21	15	150	300	600	0,285
5	26	19	220	440	880	0,456
6	27,5	23	275	550	1.100	0,675
7	31	26	450	900	1.800	0,925
8	36	31	500	1.000	2.000	1,250
9	36,5	33,5	750	1.500	3.000	1,550
10	42	36	1.000	2.000	4.000	1,95
12	43	40	1.350	2.700	5.400	2,80
14	48	49	1.925	3.950	7.700	4,06
16	56	54	2.500	5.000	10.000	5,28
18	63	60	3.150	6.300	12.600	6,50
20	70	67	4.000	8.000	16.000	8,50

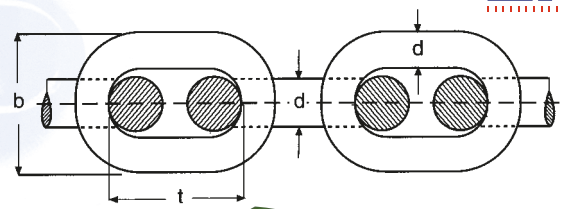

NOTA: En la cadena comercial, los datos referentes a carga útil, carga de prueba y de rotura son orientativos, sin garantía.

## • CADENA ESLABÓN OVALADO OVAL LINK CHAIN



Ø mm. (d.)	LARGO L mm.	ANCHO b mm.	PESO KG./MT.
6	45	30	0,680
7	50	35	0,944
8	51	36	1,140
10	59	40	2,000

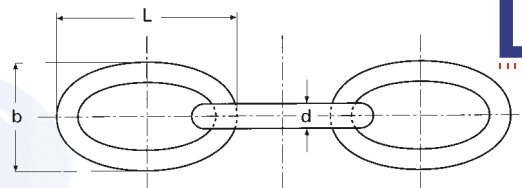

## • CADENA ESLABÓN LARGO LONG LINK CHAIN



Ø mm. (d.)	PASO t mm.	ANCHO b mm.	PESO KG./MT.
4	32	15	0,263
5	38	19	0,407
6	41	23	0,694
7	35	24	0,883
8	40	27	1,172

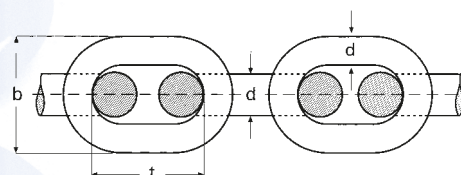

# CADENA DIN 766, PULIDA, CINCADADA Y GALVANIZADA AL FUEGO

CHAIN DIN 766: POLISHED, ZINC PLATED, AND HOT DIP GALVANISED



Ø mm. (d)	PASO t mm.	b mm.	CALIDAD NORMAL			PESO KG./MT.
			CARGA UTIL	CARGA DE PRUEBA	CARGA MINIMA DE ROTURA	
6	18	20	350	700	1.400	0,750
8	24	26	630	1.260	2.500	1,40
10	28	34	1.000	2.000	4.000	2,25

NOTA: Los datos referentes a carga útil, carga de prueba y de rotura son orientativos, sin garantía.

# CADENA COMERCIAL, PULIDA, CINCADADA Y GALVANIZADA AL FUEGO EN BOBINAS.

COMMERCIAL CHAIN ON REELS: POLISHED, ZINC PLATED, AND HOT DIP GALVANISED

Ø mm. (d)	Paso t mm.	b mm.	PESO BOBINA KG.	METRO/BOBINA
2	15	10	10	145
2,5	15	11,5	10	90
3	18,5	11	10	66
4	21	15	10	36
2	15	10	20	290
2,5	15	11,5	25	226
3	18,5	11	25	165
4	21	15	25	91
5	26	19	25	55
6	27,5	23	25	38
7	31	26	25	28
8	36	31	25	21
9	36,5	33,5	25	16
10	42	36	25	13
12	43	40	25	9



LOS EXPOSITORES SE SUMINISTRARÁN CON 8 BOBINAS DE CADENA.

LAS MEDIAS BOBINAS SE SUMINISTRAN EN EMBALAJE DE 2 UNIDADES.

EL EXPOSITOR TAMBIÉN SE VENDE VACÍO.

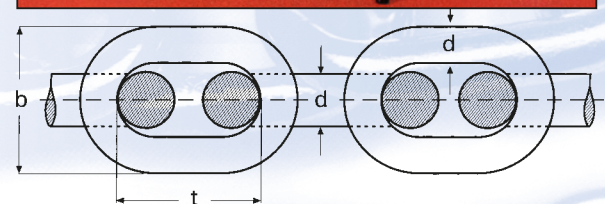

## CADENA ACERO INOXIDABLE AISI-316. STAINLESS STEEL CHAIN AISI-316

Ø mm. (d)	PASO t mm.	b mm	CARGA DE TRABAJO KG.	PESO KG./MT.	MT/CAJA
2	14	10,5	75	0,067	50
3	18,5	11	100	0,151	50
4	21	15	150	0,285	50
5	25	18,5	220	0,442	50
6	27	22	275	0,664	40
7	31	26,5	450	0,915	25
8	36	30	500	1,207	20
10	35	34	1.000	1,950	15
12	42	41	1.350	2,860	10

# CADENA EN FORMA PARA USOS AGRICOLAS Y GANADEROS.

## SHAPED CHAIN FOR ALL LIVESTOCK APPLICATIONS

### MEDIDAS DISPONIBLES

#### CADENAS RONZALES PULIDAS Y CINCADAS

ALL SIZED PET CHAINS FOR INSIDE/OUTSIDE BERTH (POLISHED AND ZINC PLATED) ①

Largo en cms.	GRUESO EN MM.					
	2	2,5	3	4	5	6
130	•	•	•	•	•	•
135	•	•	•	•	•	•
150	•	•	•	•	•	•
200	•	•	•	•	•	•
250	•	•	•	•	•	•

#### CADENAS DE BUEYES PULIDAS Y CINCADAS

CHAINS FOR COWS AND OXEN (POLISHED AND ZINC PLATED) ⑤

Largo en cms.	GRUESO EN MM.					
	3	4	5	6	7	8
80 x 46	•	•	•	•	•	
80 x 50	•	•	•	•	•	
80 x 55	•	•	•	•	•	
80 x 60	•	•	•	•	•	•
80 x 65					•	•
80 x 70					•	•

#### CADENAS PARA CABRAS PULIDAS Y CINCADAS

CHAINS FOR GOATS (POLISHED AND ZINC PLATED) ②

Largo en Mts.	GRUESO EN MM.		
	3	4	5
3	•	•	•
4	•	•	•
5	•	•	•
6	•	•	•

#### CADENAS PARA TRABAS PULIDAS Y CINCADAS

FETTER CHAINS TO ALLOW CATTLE TO GRAZE AT WILL WITHOUT STRAYING ③

Largo en cms.	MEDIDAS	GRUESO EN MM.			
		3	4	5	6
32	12-8-12	•	•	•	•
34	13-8-13	•	•	•	•
36	13-10-13	•	•	•	•
38	14-10-14		•	•	•
40	15-10-15		•	•	•
42	15-12-15		•	•	•
44	16-12-16		•	•	•

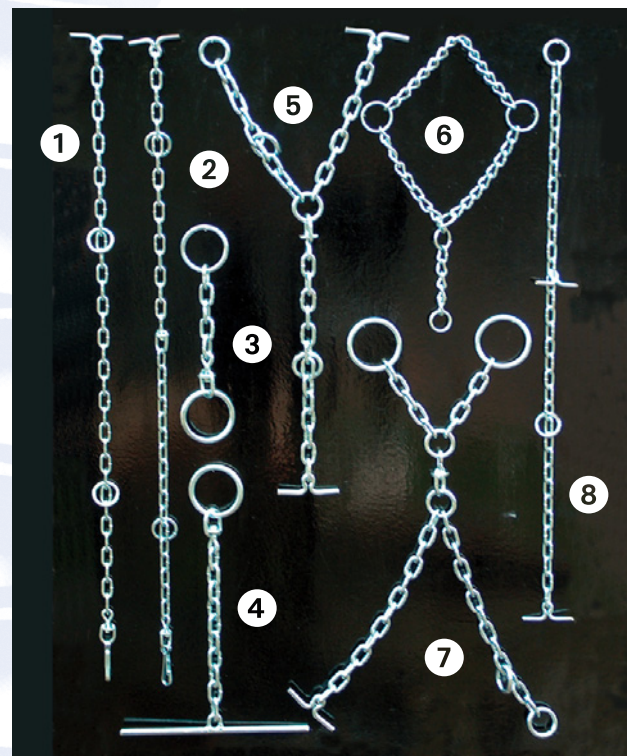

- ① RONZAL
- ② CABRA
- ③ PEAL DE ANILLA
- ④ PEAL DE VARILLA
- ⑤ BUEY
- ⑥ CABEZADA
- ⑦ BUEY PARA ESTABLO METALICO
- ⑧ TRABA

**LAR**

TAMBIÉN SE FABRICAN RAMALILLOS, CADENAS HOLANDESAS, PEALES, CABEZADAS Y BUEYES PARA ESTABLO METÁLICO.

# ● ACCESORIOS PARA CADENA EN FORMA

## ALL KIND OF ACCESSORIES FOR SHAPED CHAINS.

**LAR**

- ① MULETILLAS
- ② ANILLAS
- ③ GIRATORIOS
- ④ ANILLAS CON GIRATORIO

● MEDIDAS DISPONIBLES

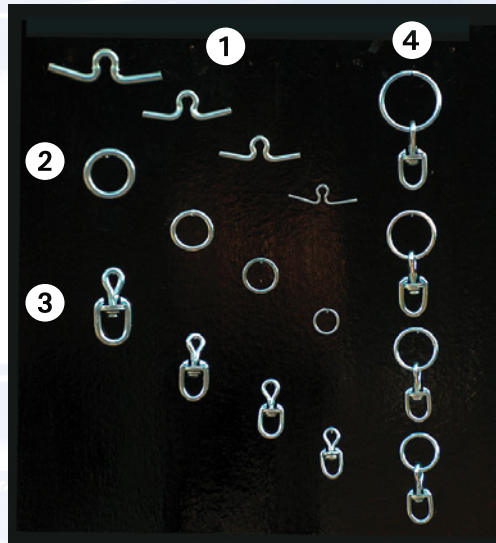

### ● ANILLAS SOLDADAS PULIDAS Y CINCADAS

WELDED RINGS (POLISHED AND ZINC PLATED)

LUZ EN mm.	GRUESO EN MILIMETROS			
	4	5	6	7
25	●	●	●	
30	●	●	●	●
35	●	●	●	●
40	●	●	●	●
45	●	●	●	●
50	●	●	●	●
55	●	●	●	●
60	●	●	●	●

**LAR**

### ● TORNQUETE GIRATORIOS PULIDOS Y CINCADOS

SWIVELS (POLISHED AND ZINC PLATED)

Para cadena de 3 y 4  
 Para cadena de 5 y 6  
 Para cadena de 7 y 8

**LAR**

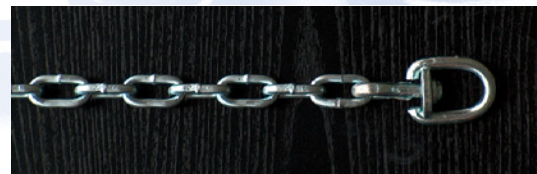

### ● MULETILLAS PULIDAS Y CINCADAS

TOWING PINS (POLISHED AND ZINC PLATED)

Para cadena de 3  
 Para cadena de 4  
 Para cadena de 5  
 Para cadena de 7

**LAR**

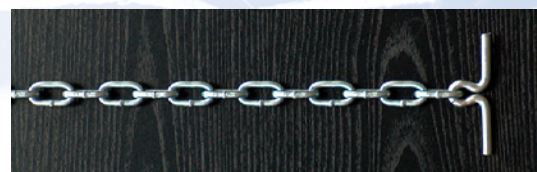

# ACCESORIOS PARA CADENA Y CABLE

## ACCESSORIES FOR CHAINS AND WIRE ROPES (HARDWARE RIGGING)

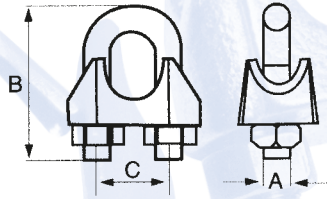

**LAR**

### SUJETACABLE DIN 741 GALVANIZADO

WIRE ROPE CLIP DIN 741 (ZINC PLATED)

CÓDIGO	Medida m/m	Medida equiv.	A	B m/m	C m/m	Kgs. 100pz.	
L8872203	3	1/8"	M-4	20	9	0,7	200
L8872205	5	3/16"	M-5	24	11	1,5	200
L8872206	6	1/4"	M-5	28	13	2	200
L8872208	8	5/16"	M-6	34	16	3,5	100
L8872210	10	3/8"	M-8	42	19	6,5	50
L8872211	11	7/16"	M-8	44	20	7,5	50
L8872213	13	1/2"	M-10	55	24	12,9	50
L8872214	14	9/16"	M-10	57	25	14	50
L8872216	16	5/8"	M-12	63	29	21,6	25
L8872219	19	3/4"	M-12	75	32	29,6	25
L8872222	22	7/8"	M-14	85	37	35,2	20
L8872226	26	1"	M-14	95	41	38	20
L8872230	30	1 1/8"	M-16	110	48	59,8	10
L8872234	34	1 1/4"	M-16	120	52	75,5	5
L8872240	40	1 1/2"	M-16	140	58	91,2	5

### SUJETACABLE PLANO SIMPLE GALVANIZADO

#### SIMPLEX WIRE ROPE CLIP (ZINC PLATED)

CÓDIGO	Medida m/m	L m/m	B m/m	C m/m	D	Kgs. 100pz.	
L8671602	2	18	7	5	M-4	0,5	200
L8671603	3	18	10	6	M-4	0,7	200
L8671604	4	22	12	7	M-5	1,3	200
L8671605	5	24	14	8	M-5	1,7	100
L8671606	6	30	17	10	M-6	2,5	100

**LAR**

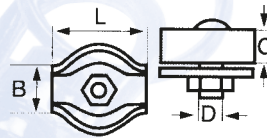

**LAR**

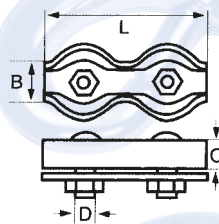

### SUJETACABLE DOBLE PLANO GALVANIZADO

DUPLEX WIRE ROPE CLIP (ZINC PLATED)

CÓDIGO	Medida m/m	L m/m	B m/m	C m/m	D	Kgs. 100pz.	
L8671702	2	38	7	5	M-4	0,9	100
L8671703	3	38	10	6	M-4	1,4	100
L8671704	4	47	12	7	M-5	2,5	100
L8671705	5	51	14	8	M-5	3,4	50
L8671706	6	63	17	10	M-6	5,0	50

### CANCAMO MACHO DIN 580 GALVANIZADO

#### EYE BOLT NUTS DIN 580 (ZINC PLATED)

CÓDIGO	D	A m/m	B m/m	H m/m	L m/m	S.W.L. Kgs.	Kgs. 100pz.	
L8973706	M-6	20	36	36	13	90	5,5	50
L8973708	M-8	20	36	36	13	140	6	50
L8973710	M-10	25	45	45	17	230	11	25
L8973712	M-12	30	54	53	20	340	17	25
L8973714	M-14	30	54	53	20	500	18	10
L8973716	M-16	35	63	62	27	700	30	10
L8973718	M-18	35	63	62	27	900	42	10
L8973720	M-20	40	72	71	30	1200	48	10
L8973722	M-22	40	72	71	30	1450	60	5
L8973724	M-24	50	90	90	36	1700	90	5
L8973730	M-30	60	108	109	45	3600	166	2

**LAR**

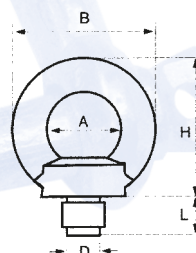

## • CANCAMO HEMBRA DIN 582 GALVANIZADO

EYE BOLT NUTS DIN 582 (ZINC PLATED)

**LAR**

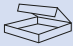
CÓDIGO	D	A m/m	B m/m	H m/m	E m/m	S.W.L. Kgs.		
L8973806	M-6	20	36	36	8	90	4,5	50
L8973808	M-8	20	36	36	8	140	5,5	50
L8973810	M-10	25	45	45	10	230	10	25
L8973812	M-12	30	54	53	12	340	16	25
L8973814	M-14	30	54	53	12	500	17	10
L8973816	M-16	35	63	62	14	700	26	10
L8973818	M-18	35	63	62	14	900	29	10
L8973820	M-20	40	72	71	16	1200	41	10
L8973822	M-22	40	72	71	16	1450	56	5
L8973824	M-24	50	90	90	20	1700	76	5
L8973830	M-30	60	108	109	24	3600	140	2

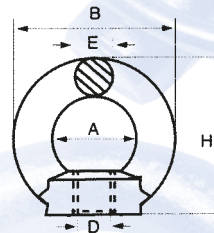



## • CANCAMO HEMBRA OVAL GALVANIZADO

OVAL EYE BOLT NUTS (ZINC PLATED)

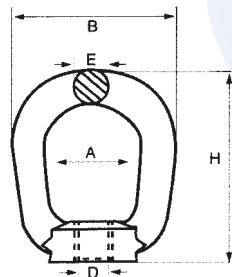

**LAR**



CÓDIGO	D	A m/m	B m/m	H m/m	E m/m	S.W.L. Kgs.		
L8974410	M-10	24	44	58	10	160	14	10
L8974412	M-12	30	56	72	13	250	26	10
L8974416	M-16	36	68	86	16	400	43	5
L8974420	M-20	42	80	100	19	630	59	2

## • TENSOR COMERCIAL GANCHO-ANILLA GALVANIZADO

COMMERCIAL H-E TURNBUCKLES (ZINC PLATED)

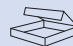
CÓDIGO	Medida	Medida equiv.	L m/m	L1 m/m	B m/m	S.W.L. Kgs.		
L9672405	M-5	3/16"	50	35	17	30	3	100
L9672406	M-6	1/4"	60	55	20	50	5	100
L9672408	M-8	5/16"	70	57	24	100	6,5	50
L9672410	M-10	3/8"	80	68	35	140	15	25

**LAR**

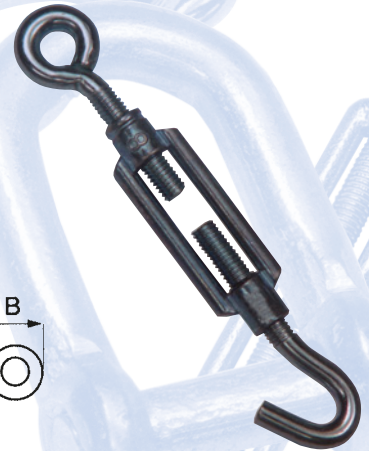
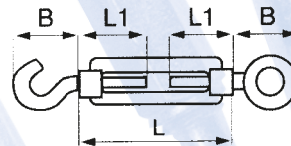



## • TENSOR DIN 1480 GANCHO-ANILLA GALVANIZADO

H-E TURNBUCKLES DIN 1480 (ZINC PLATED)

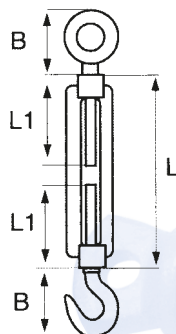

**LAR**



CÓDIGO	Medida	Medida equiv.	L m/m	L1 m/m	B m/m	S.W.L. Kgs.		
L9672505	M-5	3/16"	80	40	19	50	5	50
L9672506	M-6	1/4"	90	50	24	75	6	50
L9672508	M-8	5/16"	110	52	28	165	12	40
L9672510	M-10	3/8"	130	62	37	230	24	40
L9672512	M-12	1/2"	140	65	39	320	38	25
L9672514	M-14	9/16"	170	80	43	420	56	20
L9672516	M-16	5/8"	190	105	63	530	94	20
L9672520	M-20	3/4"	220	110	74	725	154	10
L9672522	M-22	7/8"	240	125	80	1110	220	10
L9672524	M-24	1"	255	135	85	1540	270	10
L9672527	M-27	-	300	135	85	1870	390	2
L9672530	M-30	1 1/8"	255	145	90	2240	570	1

## • TENSOR DIN I480 VARILLA-VARILLA

STUBENDS DIN 1480

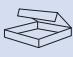
CÓDIGO	Medida	Medida equiv.	L m/m	L1 m/m	B m/m	S.W.L. Kgs.	Kgs. 100pz.	
L9672812	M-12	1/2"	140	75	75	910	40	10
L9672816	M-16	5/8"	190	100	100	1750	95	5
L9672820	M-20	3/4"	220	120	100	2700	160	2
L9672824	M-24	1"	255	150	110	3920	282	2

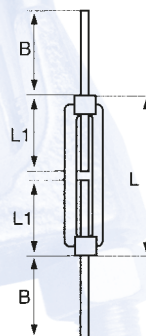

**LAR**



**LAR**

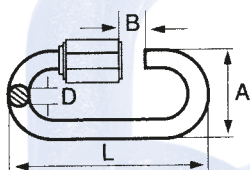

## • ESLABÓN RÁPIDO CON VIROLA GALVANIZADO

QUICK LINK WITH NUT (ZINC PLATED)

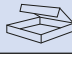
CÓDIGO	D m/m	L m/m	A m/m	B m/m	Kgs. 100pz.	
L9273903	3,5	37	17	5	1	100
L9273904	4	41	20	5	1,2	100
L9273905	5	50	23	6	2,2	100
L9273906	6	58	27	7,5	3	50
L9273907	7	66	30	8,5	5,5	50
L9273908	8	74	34	10	8	50
L9273909	9	80	37	12	11	25
L9273910	10	90	41	13	15	25
L9273912	12	105	48	15	23	25

## • GRILLETE GIRATORIO ACERO DOBLE GALVANIZADO

DUPLEX SWIVEL TYPE SHACKLES (ZINC PLATED)

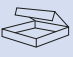
CÓDIGO	D m/m	L m/m	A m/m	B m/m	S.W.L. Kgs.	Kgs. 100pz.	
L8776501	6	87	19	32	150	9	10
L8776502	8	107	26	42	250	16	10
L8776503	10	130	31	51	300	31	10
L8776506	12	163	38	63	650	61	5
L8776510	16	199	45	77	1000	102	2
L8776520	20	258	65	105	2000	223	2

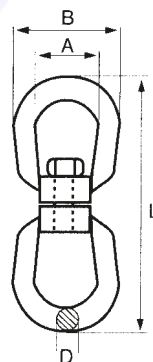

**LAR**

**LAR**

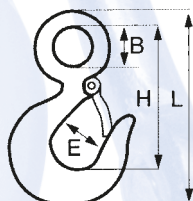

## • GANCHO CARGA DIN 689 CON GATILLO GALVANIZADO

HOOK WITH LATCH DIN 689 (ZINC PLATED)

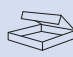
CÓDIGO	S.W.L. Kgs.	H m/m	L m/m	E m/m	B m/m	Kgs. 100pz.	
L8974025	250	64	89	15	13	15	10
L8974050	500	83	118	22	16	32	10
L8974100	1000	114	162	25	20	85	10
L8974150	1600	136	190	31	26	130	5
L8974300	2500	170	244	39	30	250	3



## • GRILLETE RECTO GALVANIZADO DEE TYPE SHACKLES (ZINC PLATED)

**LAR**

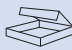
CÓDIGO	D-d m/m	Medida equiv.	B m/m	H m/m	A m/m	S.W.L. Kgs.	Kgs. 100pz.	
L8770803	3,5	1/8"	7	14	15	50	1	100
L8770805	5	3/16"	10	20	20	80	1,6	100
L8770806	6	1/4"	13	24	25	100	3	100
L8770808	8	5/16"	16	32	32	200	7	50
L8770810	10	3/8"	19	38	39	310	13	50
L8770811	11	7/16"	22	44	44	400	16	25
L8770812	12	1/2"	25	50	50	520	22	25
L8770814	14	9/16"	28	56	56	650	33	10
L8770816	16	5/8"	32	64	64	800	51	10
L8770818	18	-	32	70	72	1000	65	10
L8770820	20	3/4"	38	76	78	1100	92	10
L8770822	22	7/8"	44	88	88	1500	132	6
L8770825	25	1"	50	100	101	2100	208	5
L8770828	28	1 1/8"	57	114	114	3000	290	2
L8770832	32	1 1/4"	64	128	128	3500	317	2
L8770836	36	1 1/2"	72	140	144	4200	580	1
L8770838	38	-	76	152	152	5000	615	1
L8770842	42	-	84	166	168	6000	780	1
L8770845	45	1 3/4"	90	180	180	7000	1100	1
L8770850	50	2"	102	200	202	8000	1400	1

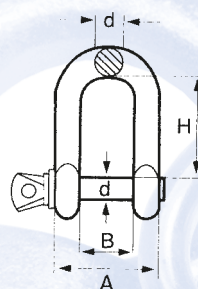

**LAR**

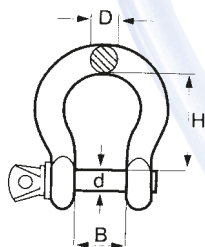

## • GRILLETE LIRA ALTA RESISTENCIA GALVANIZADO HIGH TENSILE BOW SHACKLES (ZINC PLATED)

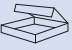
CÓDIGO	D m/m	Medida equiv.	d m/m	B m/m	H m/m	S.W.L. Kgs.	Kgs. 100pz.	
L8776308	6	1/4"	8	12	29	500	7	10
L8776309	8	5/16"	10	13	32	750	13	10
L8776310	10	3/8"	11	17	37	1000	17	10
L8776315	11	7/16"	12	19	43	1500	25	10
L8776320	13	1/2"	16	22	51	2000	44	10
L8776330	16	5/8"	19	27	64	3250	79	10
L8776340	19	3/4"	22	31	76	4750	127	2
L8776365	22	7/8"	25	36	83	6500	189	2
L8776385	25	1"	28	43	95	8500	279	2
L8776386	28	1 1/8"	32	47	108	9500	387	1
L8776387	32	1 1/4"	35	51	115	12000	525	1
L8776388	35	1 3/8"	38	57	133	13500	694	1
L8776389	38	1 1/2"	42	60	146	17000	880	1

## • TORNQUETE GIRATORIO REDONDO NIQUELADO ROUND SWIVEL (NICKLE PLATED)

**LAR**

CÓDIGO	L m/m	D1 m/m	D2 m/m	Kgs. 100pz.	
L8270650	50	13	13	2,1	100
L8270660	60	16	16	3,4	100
L8270665	65	20	20	3,7	100
L8270670	70	22	22	4,8	50
L8270680	80	25	25	5	50

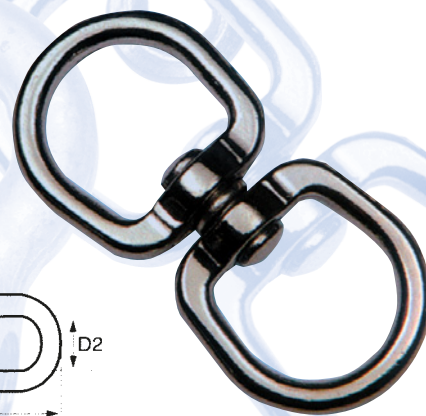
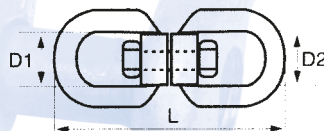

**• MOSQUETÓN ZAMAK NIQUELADO**  
ZAMAK (NICKLE PLATED)

CÓDIGO	L m/m	d m/m	m m/m	Kgs. 100pz.	
L8210050	53	10	6	1	100
L8210054	56	14	7	1,1	100
L8210060	60	12	7	1,7	100
L8210065	65	13	7	1,8	100
L8210069	70	13	8	2,4	100
L8210075	76	13	10	2,7	100
L8210082	83	19	10	2,8	50
L8210095	90	24	8	3,9	50

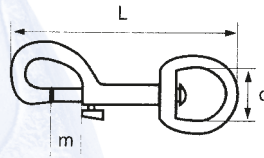

**• MOSQUETÓN ZAMAK CON LLAVERO NIQUELADO**  
ZAMAK WITH RING (NICKLE PLATED)

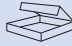
CÓDIGO	L1 m/m	d1 m/m	m m/m	L2 m/m	Kgs. 100pz.	
L8214075	75	24	10	99	2,8	100

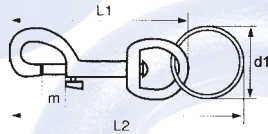

**• MOSQUETÓN BOMBERO GALVANIZADO**  
SNAP HOOK (ZINC PLATED)

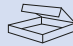
CÓDIGO	L m/m	D m/m	A m/m	B m/m	C m/m	S.W.L. Kgs.	Kgs. 100pz.	
L8070040	40	4	7	4	7	30	1	200
L8070050	50	5	8	5	7	100	1,9	100
L8070060	60	6	9	6	8	120	2,7	100
L8070070	70	7	11	8	8	180	4,4	100
L8070080	80	8	12	9	9	230	6,5	50
L8070090	90	9	13	10	10	250	9	50
L8070100	100	10	15	11	12	350	12	25
L8070120	120	11	18	12	17	380	18	25
L8070140	140	12	20	15	19	400	24	15

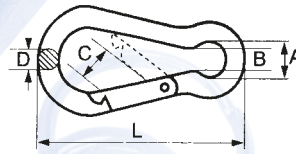

**• MOSQUETÓN BOMBERO CON VIROLA GALVANIZADO**  
SNAP HOOK WITH NUT (ZINC PLATED)

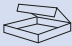
CÓDIGO	L m/m	D m/m	A m/m	B m/m	C m/m	S.W.L. Kgs.	Kgs. 100pz.	
L8371050	50	5	8	5	6	100	2	100
L8371060	60	6	9	6	7	120	3	100
L8371070	70	7	11	8	7	180	4,6	50
L8371080	80	8	12	9	8	230	7	50
L8371090	90	9	13	10	8	250	9,5	40
L8371100	100	10	15	11	10	350	13	25
L8371120	120	11	18	12	15	450	19	20
L8371140	140	12	20	15	17	510	26	15

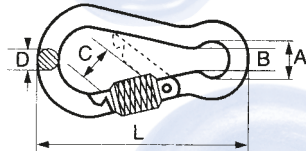

**• MOSQUETÓN BOMBERO CON TORNIQUETE GALVANIZADO**  
SNAP HOOK WITH SWIVEL (ZINC PLATED)

CÓDIGO	L m/m	D m/m	C m/m	L2 m/m	d2 m/m	Kgs. 100pz.	
L8030050	50	5	7	45	3	3,9	50
L8030060	60	6	8	45	3	4,7	50
L8030070	70	7	8	65	4	8	50
L8030080	80	8	9	65	4	10	25
L8030100	100	10	12	75	5	18	25

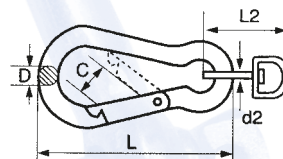

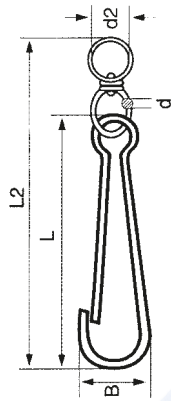

• **MOSQUETÓN ACERO CON TORNQUETE NIQUELADO**  
SNAP HOOK WITH SWIVEL (NICKLE PLATED)

CÓDIGO	L m/m	L2 m/m	B m/m	d2 m/m	d m/m	Kgs. 100pz.	
L8172025	25	53	10	9	1,4	0,5	200
L8172030	30	55	11	7	1,6	0,5	200
L8172040	40	70	13	9	1,6	0,8	200
L8172050	50	83	15	10	2	1	100
L8172060	60	98	17	12	2,2	2,2	100
L8172070	70	110	20	13	2,5	3,2	100
L8172080	80	130	23	14	3	3,5	50
L8172090	90	143	26	16	4	6	50
L8172100	100	165	29	19	4	7	25

• **MOSQUETÓN ALUMINIO COLORES CON LLAVERO**

ALUMINIUM SNAP HOOK WITH RING (COLOURED)

CÓDIGO	L m/m	D m/m	A m/m	E m/m	C m/m	Kgs. 100pz.	
L8220050	50	5	8	15	6	0,7	50
L8220060	60	6	9	18	9	1	50
L8220070	70	7	10	22	10	1,7	50
L8220080	80	8	12	26	12	2	50

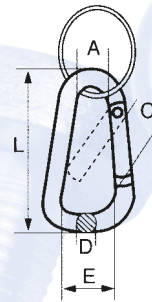

• **LLAVERO ACERO NIQUELADO**  
KEY RING (NICKLE PLATED)

CÓDIGO	L m/m	D m/m	d m/m	Kgs. 100pz.	
L8571516	16	12	2	0,1	100
L8571518	18	14	2	0,2	100
L8571520	20	15	3	0,2	100
L8571525	25	21	3	0,3	100
L8571530	30	25	3	0,4	100
L8571535	35	30	4	0,7	100
L8571540	40	35	4	0,8	100

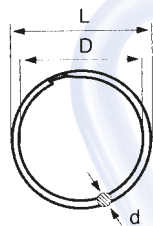

• **GUARDACABO FORMA CORAZÓN DIN 6899 GALVANIZADO**

THIMBLES DIN 6899 (ZINC PLATED)

CÓDIGO	Ø Cable m/m	L	C m/m	D m/m	H m/m	Kgs. 100pz.	
L9573603	2/3	3/4"	4	10	22	0,3	100
L9573604	4	1"	5	12	28	0,4	100
L9573605	5	1 1/8"	6	14	30	0,6	100
L9573606	6	1 1/4"	7	15	33	0,8	100
L9573607	7	1 1/2"	8	16	35	1	100
L9573608	8	1 3/4"	9	18	39	1,6	100
L9573610	10	2"	11	22	47	3	50
L9573612	12	2 1/2"	13	26	56	5,2	50
L9573613	14	3"	14	30	67	7,3	50
L9573616	16	3 1/2"	18	35	78	18	40
L9573618	18	4"	20	40	86	27	20
L9573620	20	4 1/4"	22	46	89	36	20

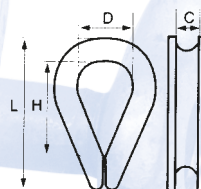

**LAR**

• **ABARCON PARA TUBO CON TUERCA GALVANIZADO**

U-BOLT (ZINC PLATED)

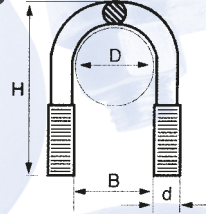

CÓDIGO	B m/m	H m/m	D	d m/m	Kgs. 100pz.	
L9877410	17	37	3/8"	M-6	2,2	25
L9877415	21	41	1/2"	M-6	2,4	25
L9877420	27	47	3/4"	M-6	2,7	25
L9877425	34	54	1"	M-6	3	25
L9877432	42	62	1 1/4"	M-6	3,4	25
L9877440	48	69	1 1/2"	M-8	7	25
L9877450	60	83	2"	M-8	8	25
L9877465	76	98	2 1/2"	M-8	9,5	25
L9877480	89	110	3"	M-10	11	20
L9877499	114	140	4"	M-10	13	20
L9877497	140	166	5"	M-10	15	10

• **GANCHO FORMA "S" GALVANIZADO**

"S" TYPE HOOK (ZINC PLATED)

CÓDIGO	A m/m	D m/m	C m/m	Kgs. 100pz.	
L8475020	20	2	4	0,1	200
L8475025	25	2,2	5	0,2	200
L8475030	30	2,7	6	0,3	200
L8475035	35	3,5	7	0,5	200
L8475040	40	4	9	0,8	200
L8475045	45	4	9	0,8	200
L8475050	50	4,5	9	1,3	200
L8475055	55	4,5	11	1,4	100
L8475060	60	5	8	1,9	100
L8475070	70	6	8	3,2	100
L8475080	80	6	9	3,8	50
L8475090	90	7	11	5,8	25
L8475100	100	7	11	6	25

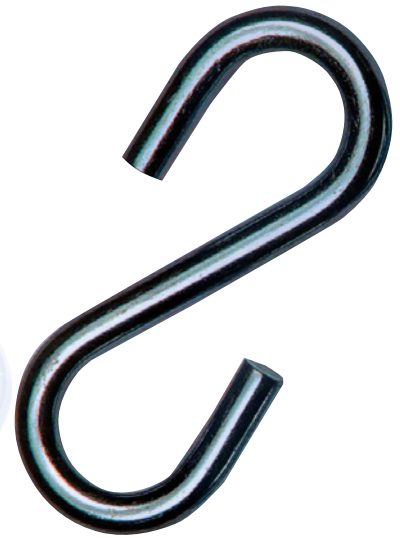
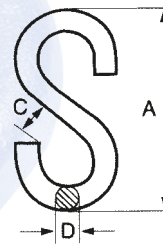

**LAR**

• **ANILLA SOLDADA GALVANIZADA**

ROUND RING (ZINC PLATED)



**LAR**

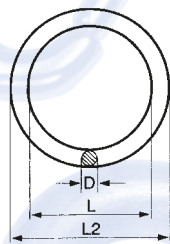

CÓDIGO	L m/m	D m/m	L2 m/m	Kgs. 100pz.	
L9476020	20	3	26	0,4	200
L9476025	25	3,5	32	0,7	200
L9476030	30	3,5	37	0,9	200
L9476035	35	5	45	2	100
L9476040	40	5	50	2,3	100
L9476050	50	6	62	4	50
L9476060	60	6	72	4,8	50
L9476070	70	6	82	5,8	25
L9476080	80	8	96	11,5	20
L9476100	100	12	124	31,8	15

• **PIQUETE FUERTE SOLDADO GALVANIZADO**

"D" TYPE RING (ZINC PLATED)

CÓDIGO	L m/m	D m/m	L2 m/m	Kgs. 100pz.	
L9475920	20	3,5	27	0,8	200
L9475925	25	3,5	32	0,8	200
L9475930	30	5	40	1,9	100
L9475940	40	6	52	3,4	50
L9475950	50	8	68	6	25

**LAR**

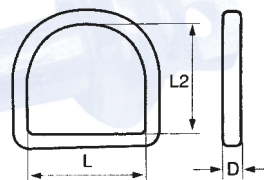

• **PASADOR "ANILLA" GALVANIZADO AMARILLO**

LYNCH PIN (GOLDEN ZINC PLATED)

**LAR**

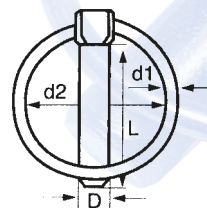

CÓDIGO	D m/m	L m/m	d1 m/m	d2 m/m	Kgs. 100pz.		
L9175704	4,5	30	2	22	0,8		100
L9175705	5	40	2,5	24	1,3		100
L9175706	6	45	3	25	2		100
L9175707	7	45	3	28	2,6		100
L9175708	8	45	3,5	34	3,5		100
L9175709	9	46	3,5	34	4,6		50
L9175710	10	46	3,5	34	5,3		50
L9175711	11	46	3,5	34	6,2		50

**LAR**

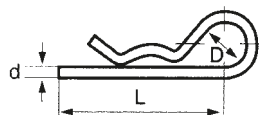
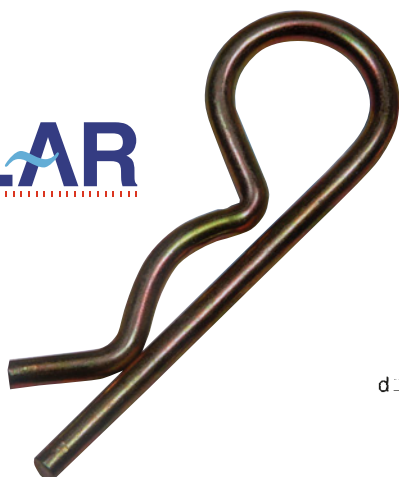

• **PASADOR FORMA "R" GALVANIZADO AMARILLO**

SPRING PIN (GOLDEN ZINC PLATED)

CÓDIGO	d m/m	L m/m	D m/m	Kgs. 100pz.		
L9175602	2	50	10	0,3		100
L9175603	3	60	18	0,8		100
L9175604	4	60	20	1,6		100
L9175605	5	85	24	3,1		100
L9175606	6	105	30	5,5		50
L9175607	7	105	30	8,3		25
L9175608	8	110	28	10,5		25

• **GANCHO DE SEGURIDAD DE OJO AUTOCIERRE (GR8)**

SAFETY EYE HOOK (GR8)

**LAR**

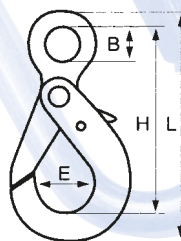

CÓDIGO	Cadena m/m	H m/m	E m/m	B m/m	S.W.L. Kgs.	Kgs. 100pz.		
L8963100	6 - 8	109	29	21	1.100	50		5
L8963200	7/8 - 8	130	35	25	2.000	80		3
L8963300	10 - 8	165	45	32	3.100	150		2

**LAR**

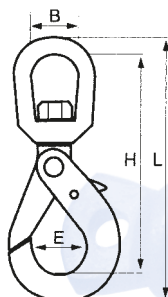

• **GANCHO DE SEGURIDAD GIRATORIO AUTOCIERRE GR8**

SAFETY SWIVEL HOOK (GR8)

CÓDIGO	Cadena m/m	H m/m	E m/m	B m/m	S.W.L. Kgs.	Kgs. 100pz.		
L8966100	6 - 8	123	29	32	1.100	60		5
L8966200	7/8 - 8	151	35	36	2.000	100		5
L8966300	10 - 8	170	45	41	3.100	220		2
L8966500	13 - 8	210	54	46	5.300	450		1

## • GANCHO DE OJO CON GATILLO SEGURIDAD GR8

EYE HOIST HOOK WITH LATCH (GR8)

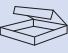
CÓDIGO	Cadena m/m	H m/m	E m/m	B m/m	S.W.L. Kgs.	Kgs. 100pz.		
L8964100	6 - 8	80	22	19	1.000	21	5	
L8964150	7 - 8	94	23	23	1.600	32	5	
L8964200	8 - 8	105	23	27	2.000	62	5	
L8964300	10 - 8	117	24	30	3.000	96	2	
L8964450	13 - 8	145	27	38	5.000	165	2	
L8964700	16 - 8	185	40	50	8.000	310	1	
L8965100	20 - 8	230	52	62	11.000	530	1	

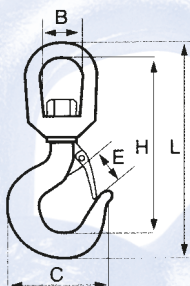
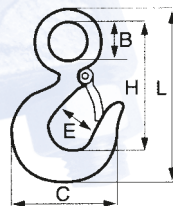

## • GANCHO GIRATORIO CON GATILLO SEGURIDAD GR8

SWIVEL HOIST HOOK WITH LATCH (GR8)

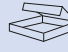
CÓDIGO	Cadena m/m	H m/m	E m/m	B m/m	S.W.L. Kgs.	Kgs. 100pz.		
L8976710	6 - 8	113	25	32	1.000	45	5	
L8976715	7 - 8	135	27	38	1.600	77	5	
L8976720	8 - 8	156	29	46	2.000	122	5	
L8976730	10 - 8	173	32	50	3.000	150	5	
L8976750	13 - 8	205	38	57	5.000	248	5	
L8976751	16 - 8	243	48	68	8.000	605	1	
L8976752	20 - 8	285	58	75	11.000	990	1	
L8976753	22 - 8	322	67	90	15.000	1500	1	

## • ESLABÓN DE CONEXIÓN GR8 (HAMMERLOCK)

CONNECTING LINK GR8 (HAMMERLOCK)

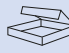
CÓDIGO	Cadena m/m	L m/m	K m/m	E m/m	D m/m	S.W.L. Kgs.	Kgs. 100pz.		
L8960019	6 - 8	42	16	16	6	1.000	8	10	
L8960020	7/8 - 8	56	19	22	9	2.000	15	5	
L8960021	10 - 8	68	25	26	11	3.200	30	4	
L8960022	13 - 8	88	29	33	16	5.400	62	8	
L8960023	16 - 8	99	37	42	18	8.000	115	3	
L8960024	20 - 8	120	42	50	20	12.500	190	2	

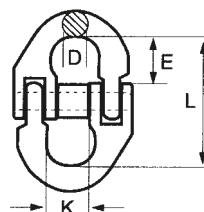

NOTA: Las fotografías, descripciones, cargas de trabajo y características contenidas en este catálogo se consideran únicamente a nivel informativo, y podrán ser modificados sin previo aviso.

## **CONDICIONES GENERALES DE VENTA**

- Todas las expediciones viajan por cuenta y riesgo del comprador y es por tanto de su exclusiva incumbencia formular las correspondientes reclamaciones de perjuicios a las empresas transportadoras o aseguradoras.
- El cobro de facturas se efectuará mediante giros o recibos pagaderos en los vencimientos de las facturas respectivas.

# CADENAS ANTIDESLIZANTES

PARA NIEVE Y PISTAS, CONSULTENOS



**LAR**  
FÁBRICA DE CADENAS  
CHAIN MANUFACTURER

**INDUSTRIAS LAR, S.L.**

Particular de Olagorta, 29

Tel.: +34 - 94 447 23 50

Fax: +34 - 94 447 23 54

info@cadenas.biz • www.cadenas.biz

48014 BILBAO - SPAIN